

# Pulse counters, electronic

<b>LCD modules</b>	<b>Adding, 6 digits (DC)</b>	<b>192</b>
--------------------	------------------------------	------------



Type 192 is a single channel counter module for PCB mounting, with a large voltage range of 8 up to 28 V DC and a 6-digit LCD display.

Extremely robust as a result of its wide temperature range, the module is ideally suited for use in many application areas.



<b>DC</b> 8 ... 28 V	<b>max.</b> 100 Hz	<b>PNP</b>	<b>000000</b>	<b>-40°...+80°C</b>	<b>7 LCDs</b>	<b>12345</b> <b>00000</b>
Supply voltage	Max. count frequency	Input type	High shock resistance	Temperature range	PCB mount	LCD display

### Powerful

- Count frequency up to 100 Hz.
- 6-digits LCD display, 5 mm high.
- Low operating current.
- Wide operating voltage and temperature range.
- High shock and vibration resistance.

### Simple

- Non-volatile memory (no battery).
- Single channel count input.
- Electrical reset.
- Very high reliability.
- Small size and very competitive price.

<b>Order no.</b>					
<i>Supply voltage</i>	<i>Order no.</i>	<i>Art. no.</i>	<i>Delivery specification</i>		
8 ... 28 V DC	<b>6.192.012.H00</b> <sup>1)</sup>	162 135	<ul style="list-style-type: none"> <li>• LCD counter module type 192</li> <li>• Operating instructions</li> </ul>		

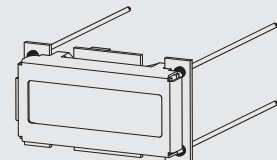

1) Stock types.

# Pulse counters, electronic

<b>LCD modules</b>	<b>Adding, 6 digits (DC)</b>	<b>192</b>
--------------------	------------------------------	------------

## Technical data

General technical data	
<b>Display</b>	6 digits, LCD display, figure height 5 mm [0.20"]
<b>Data backup</b>	EEPROM
<b>Memory</b>	CMOS EEPROM. non-volatile memory data backup up to 10 years (without battery)
<b>Operating / working / storage temperature</b>	-40 °C ... +85 °C [-40 °F ... +185 °F] (non-condensing)
<b>Humidity</b>	95 % rel +32 °C [+90 °F] for 2 hours

Inputs	
<b>Count input</b> max. counting frequency	8 ... 28 V DC 100 Hz
<b>Reset input</b> pulse length	8 ... 28 V DC min. 500 msec

Approvals	
<b>CE compliant</b> in accordance with	
EMC Directive	2014/30/EU
RoHS Directive	2011/65/EU
Low Voltage Directive	2014/35/EU
<b>UKCA compliant</b> in accordance with	
EMC Regulations	S.I. 2016/1091
RoHS Regulations	S.I. 2012/3032
Low Voltage Regulations	S.I. 2016/1101

Electrical characteristics	
<b>Supply voltage</b>	8 ... 28 V DC
<b>Current consumption</b>	max. 3 mA at 4.5 V DC 10 mA at 28 V DC
The module must be protected against inductive voltage spikes and high energy noise interference.	

Mechanical characteristics	
<b>Housing</b>	dimensions 18.4 x 32.4 mm [0.72 x 1.28"] color black
<b>Weight</b>	approx. 8 g [0.28 oz]
<b>Vibration resistance</b> acc. to EN 60068-2-6	10 ... 80 m/s <sup>2</sup> , 10 ... 75 Hz

### Dimensions

Dimensions in mm [inch]

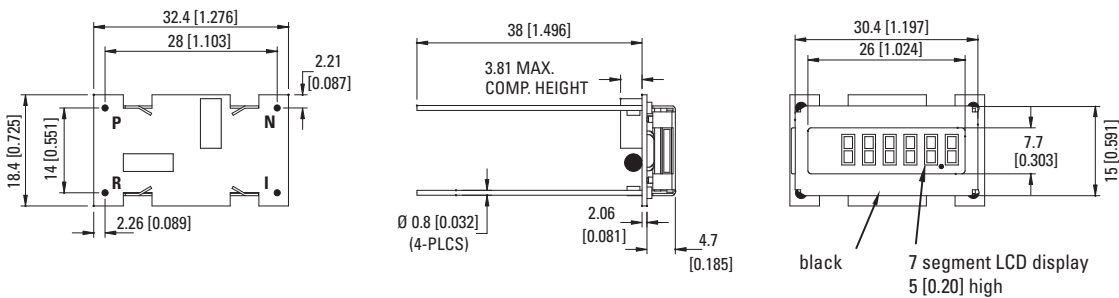

### Terminal assignment

